

Faucet Series

Stainless Steel Faucets



Lombardi®

Kitchen Faucets

Water is used in cooking the world over. We need running water in the kitchen up to 90 times each day. We take it so much for granted that we often don't think of water when we hear the word 'kitchen'. We think of well-filled refrigerators, aromas wafting from the oven and of the tables laid ready for dinner. But we forget what works hardest in the kitchen: the kitchen faucet. Something that is used this frequently must be durable - and since kitchens are increasingly becoming living spaces, it also has to look good. That's why ergonomics, functionality, aesthetics and durable finishes are so important in LOMBARDI kitchen faucets.

Lombardi Kitchen Faucet Stainless Steel

Saturnia-01



With **KEROX** Cartridge

Specification :

- Entire Stainless Steel Casting and Finishing.
- Dual-Spray pull-out faucet head
- Without toxic elements , do not release harmful substances
- No reaction with Acid or Base.
- Usage Life : Over 50 years
Life cycle tested to over 500,000 operations simulating 35-50 years of typical residential use for a family of four.

Dimensions :

All of dimension in millimeters

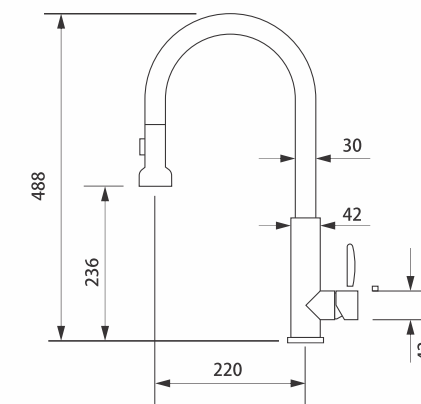

Item Number : 021501002

Lombardi®

Stainless Steel
Basin Faucets



Lombardi Basin Faucet Stainless Steel

With **KEROX** Cartridge

Specification :

- Entire Stainless Steel Casting and Finishing.
- Without toxic elements , do not release harmful substances
- No reaction with Acid or Base.
- Usage Life : Over 50 years
Life cycle tested to over 500,000 operations simulating 35-50 years of typical residential use for a family of four.



Saturnia-02



Saturnia-03

Dimensions :

All of dimension in millimeters

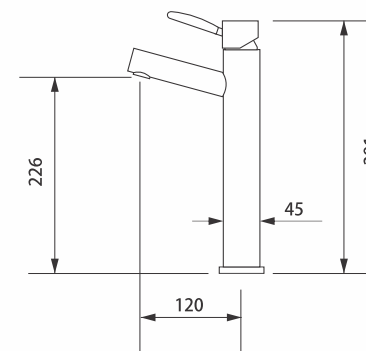

Saturnia-03
Item Number : 021501005

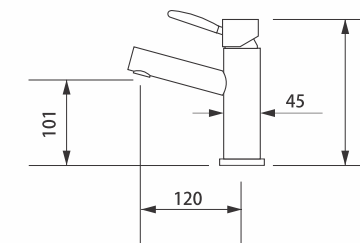

Saturnia-02
Item Number : 021501006

Shower Set

The LOMBARDI Shower Systems are a combination of modern, contemporary design and functional excellence. The aesthetic has been skillfully reduced to ensure perfect proportions and consistent geometry, while the coordinated hand and head showers enhance the visual appeal and celebrate water.



Lombardi Shower Set Stainless Steel

Saturnia

With **KEROX** Cartridge

Specification :

- Entire Stainless Steel Casting and Finishing.
- Without toxic elements , do not release harmful substances
- No reaction with Acid or Base.
- Usage Life : Over 50 years
Life cycle tested to over 500,000 operations simulating 35-50 years of typical residential use for a family of four.

NOTE : Shower Set (Saturnia-04) and
Shower Faucet (Saturnia-05)
should be ordered separately.



Dimensions :

All of dimension in millimeters

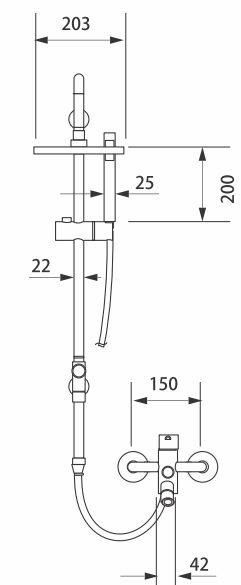
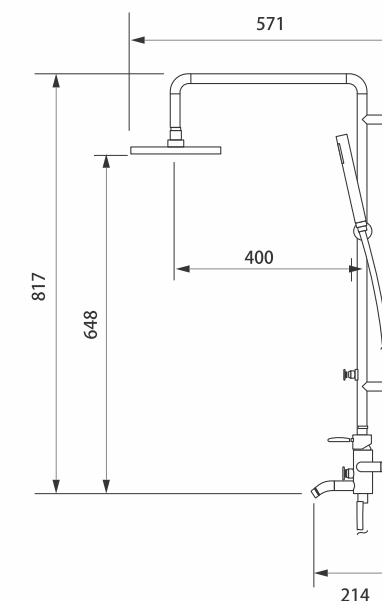

Saturnia-04
Item Number : 021501009

Saturnia-05
Item Number : 021501008

Lombardi WC Faucet Stainless Steel

Saturnia-06



With **KEROX** Cartridge

Specification :

- Entire Stainless Steel Casting and Finishing.
- Without toxic elements , do not release harmful substances
- No reaction with Acid or Base.
- Usage Life : Over 50 years
Life cycle tested to over 500,000 operations simulating 35-50 years of typical residential use for a family of four.

Y010

Item Number : 022302001



+ Stainless Steel Nozzle

Dimensions :

All of dimension in millimeters

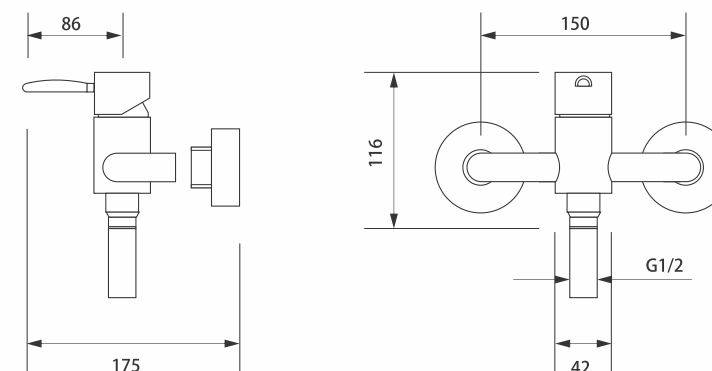

Item Number : 021501007

Kitchen Accessories

Optional soap/lotion dispensers and escutcheon plates are available to optimize the functionality of your kitchen workspace. Matching finishes make these accessories the ideal complement to any LOMBARDI faucet. In situations where you can drill countertops to customize your needs, soap/lotion dispensers allow several options. But soap/lotion dispensers and escutcheons become indispensable when adapting to sinks with several existing mounting holes.

Lombardi Soap/Lotion Dispenser Stainless Steel

Y009

Specification :

- Healthiness : Without toxic elements , non-release harmful substances
- Environmental Capacity : No threat by chemicals , no need to change
- Usage Life : Over 50 years



Lombardi Basin Drainer Stainless Steel

Y008



Dimensions :

All of dimension in millimeters

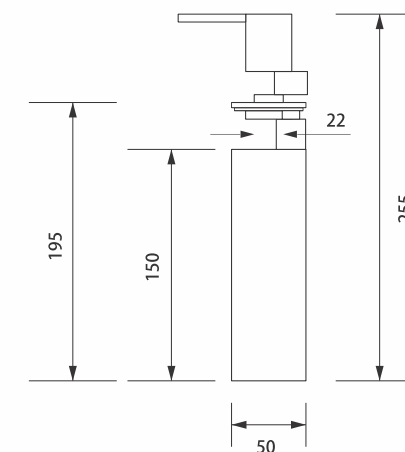

Item Number : 022301002

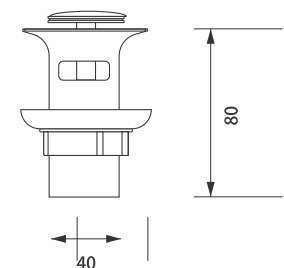

Item Number : 022301001



All of our LOMBARDI faucets contain the KEROX cartridges

About KEROX cartridges

The key to Kerox' outstanding reputation is its multi-stage quality control system that tracks each product through the entire production process.

These stages include:

- Incoming inspection for outsourced cartridge components
- thorough inspection and press trials of mold tooling before being approved for production use.
- Testing of individual components prior to assembly
- Testing at sub-assembly stages
- Final testing of completed cartridges (100%)

These basic quality guidelines are then carefully applied to the following specific components and assemblies:

Ceramic Discs: The discs, made from select European raw material, are 100% inspected with an Automatic Optical Inspection (AOI) system, providing exacting analysis of all surfaces, edges and main dimensions. Process Control techniques are used throughout the manufacturing processes to carefully monitor and keep under control such product characteristics as surface roughness, flatness and contact surface area ratio.

These steps are critical in assuring leak resistance, low torque, low operating forces, and long term reliability in every Kerox cartridge.

Plastic Components - dimensional exactness is assured by computer controlled injection molding processes, as well as thorough inspection procedures.

Outsourced Components - a strict incoming inspection procedure allows only dimensionally correct parts to enter the production flow.

Tooling - Kerox maintains an on-going monitoring of the condition of its tooling to guard against possible degradation of quality. Tooling is kept in first-rate condition at all times.

Sub-assembly testing - each cartridge is checked in every sub-assembly stage and approved before being allowed to enter the next production phase. Before leaving the plant each Kerox cartridges goes through a last inspection.

Final Testing - After assembly, each cartridge is tested to be leak-free using a pneumatic process that provides far greater sensitivity than water. After successful testing, cartridges are stamped with a confirming serial number that can be used for future tracing in the event of a field problem.

